

SPL6R

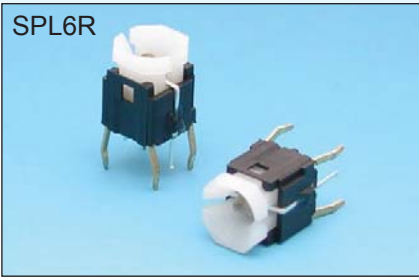

SPECIFICATIONS

CIRCUIT: SPST
 CONTACT RATING: 10mA
 VOLTAGE RATING: 12VDC
 DIELECTRIC WITH STANDING VOLTAGE: 250VAC for 1 minute
 CONTACT RESISTANCE: 500Ω max.(initial)
 INSULATION RESISTANCE: 100MΩ min.
 OPERATION LIFE: 100,000 cycles
 SOLDERING SPECIFICATION: 260°C for 3 seconds

CONDUCTIVE RUBBER CONTACT

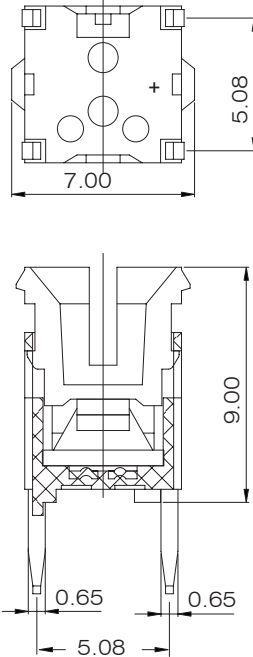
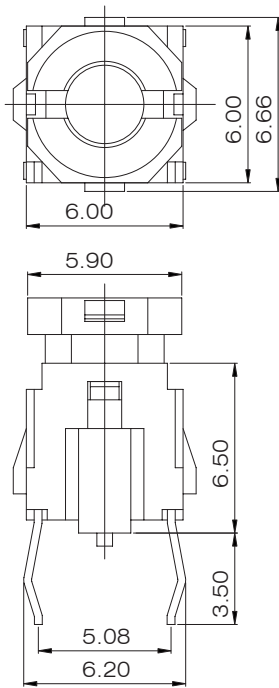

CIRCUIT

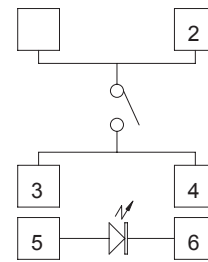

PCB LAYOUT

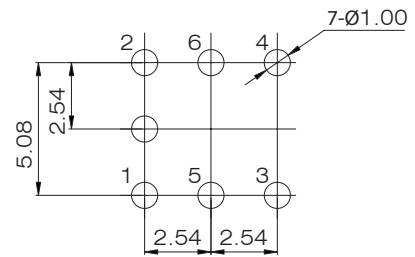

HOW TO ORDER



SWITCH OPERATION LED RoHS
 FORCE COLOR code

B = DIP Type

Operation Force
 1 = 100gf

H= RoHS Compliant

- = Without Led
- 1 = White
- 3 = Red
- 5 = Yellow
- 6 = Green