



# SPL

## SPL6B/SPL6C Illuminated Tact Switches



### SPECIFICATIONS

- CIRCUIT: SPST
- CONTACT RATING: 50mA
- VOLTAGE RATING: 12VDC
- DIELECTRIC WITH STANDING VOLTAGE: 250 VAC for 1 minute
- CONTACT RESISTANCE: 100mΩ max. (initial)
- INSULATION RESISTANCE: 100MΩ min.
- OPERATION LIFE: 100,000 cycles min.
- SOLDERING SPECIFICATION: 260 °C for 3 seconds

INDEX  
TOGGLE  
ROCKER  
SLIDE  
PUSH BUTTON  
DIP  
TACT

#### SPL6B

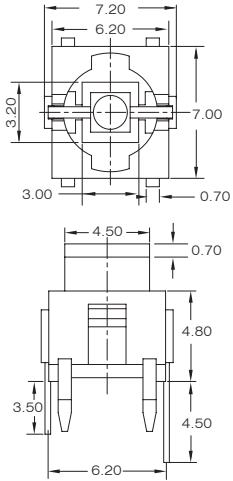

#### CIRCUIT DIAGRAM

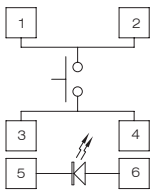

#### SPL6C

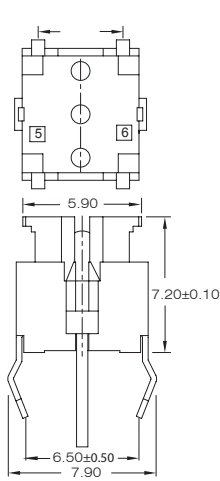

#### PCB LAYOUT

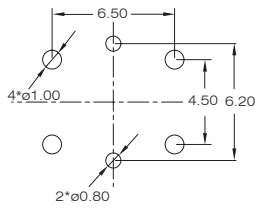

#### SPL6C

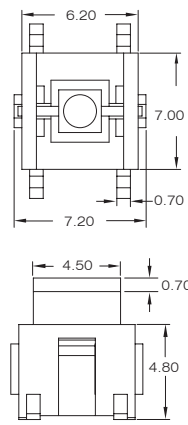

#### CIRCUIT DIAGRAM

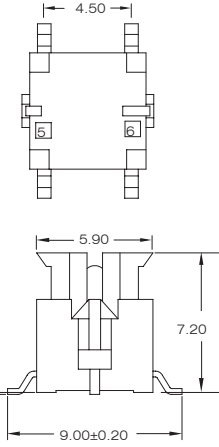
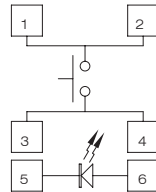

#### PCB LAYOUT

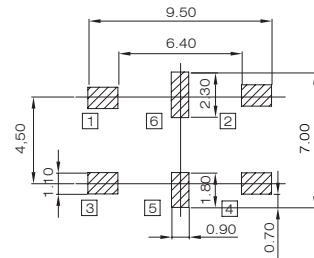

### CAP OPTIONS

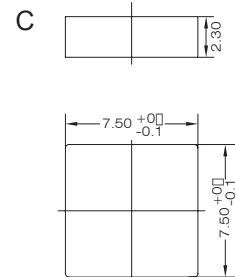
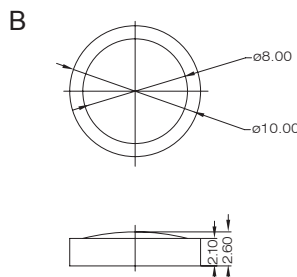
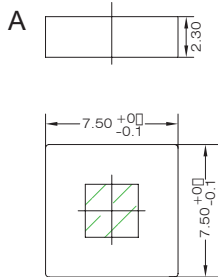

### HOW TO ORDER

SPL6  —  —  —  —  —

SWITCH      OPERATION FORCE      LED COLOR      CAP MODEL      CAP COLOR      RoHS code

B = Regular Type      Operation Force       = Without Led       = Without Cap      1 = White      H = RoHS Compliant  
 C = SMT Type      1 = 100gf      1 = White      A =       2 = Black  
                          2 = 160gf      3 = Red      B =       3 = Red  
                          3 = 260gf      5 = Yellow      C =       5 = Yellow  
                                                               6 = Green      6 = Green  
                                                               7 = Blue      7 = Blue